



TAI-SAW TECHNOLOGY CO., LTD.

No. 3, Industrial 2nd Rd., Ping-Chen Industrial District,
Taoyuan, 324, Taiwan, R.O.C.

TEL: 886-3-4690038 FAX: 886-3-4697532

E-mail: tstsales@mail.taisaw.com Web: www.taisaw.com

Approval Sheet For Product Specification

Issued Date:

Product Name: IF SAW Filter 380 MHz

TST Parts No.:TB0198A

Customer Parts No.:_____

Company: _____
Division: _____
Approved by : _____
Date: _____

Checked by: _____ Andy Lee

Approval by: _____ Francis Chen

Date: _____ 2003/9/24



TAI-SAW TECHNOLOGY CO., LTD.

No. 3, Industrial 2nd Rd., Ping-Chen Industrial District,
Taoyuan, 324, Taiwan, R.O.C.

TEL: 886-3-4690038 FAX: 886-3-4697532

E-mail: tstsales@mail.taisaw.com Web: www.taisaw.com

IF SAW Filter 380 MHz SMD 7X5mm

MODEL NO.: TB0198A

REV. NO.1

A. MAXIMUM RATING:

1. Input power level: 0 dBm
2. Operating Temperature: -10 °C ~ +85 °C
3. Storage Temperature: -40 °C ~ +85 °C

RoHS Compliant
Lead free
Lead-free soldering

B. Characteristics :

1. Ambient Temperature: 25 °C

Characteristics	Value			Note
	Min.	Typ.	Max.	
Center frequency F_c MHz	-	380	-	-
Minimum Insertion loss I.L. dB	-	12.8	16	-
Passband Ripple (378~382MHz) dB	-	0.5	1	-
Group Delay Ripple (378~382MHz) dB		40	100	
Phase linearity (378~382MHz) rms		1.2	4	
Attenuation:(Reference level from minimum insertion loss)				dB
1) F_c-2 MHz.... F_c+2 MHz dB	-	0.51	1	-
2) F_c-250 MHz ~ F_c-30 MHz dB	40	55	-	-
3) F_c-30 MHz ~ F_c-16 MHz dB	35	54	-	-
4) F_c-16 MHz ~ F_c-4 MHz dB	30	32	-	-
5) F_c+4 MHz ~ F_c+16 MHz dB	30	32	-	-
6) F_c+16 MHz ~ F_c+30 MHz dB	35	53	-	-
7) F_c+30 MHz ~ F_c+250 MHz dB	40	55	-	-

C. Measurement Circuit:

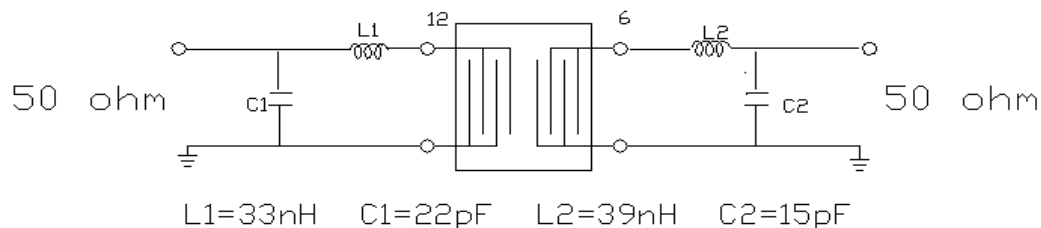

D. Frequency Characteristics :

1. S21 Response

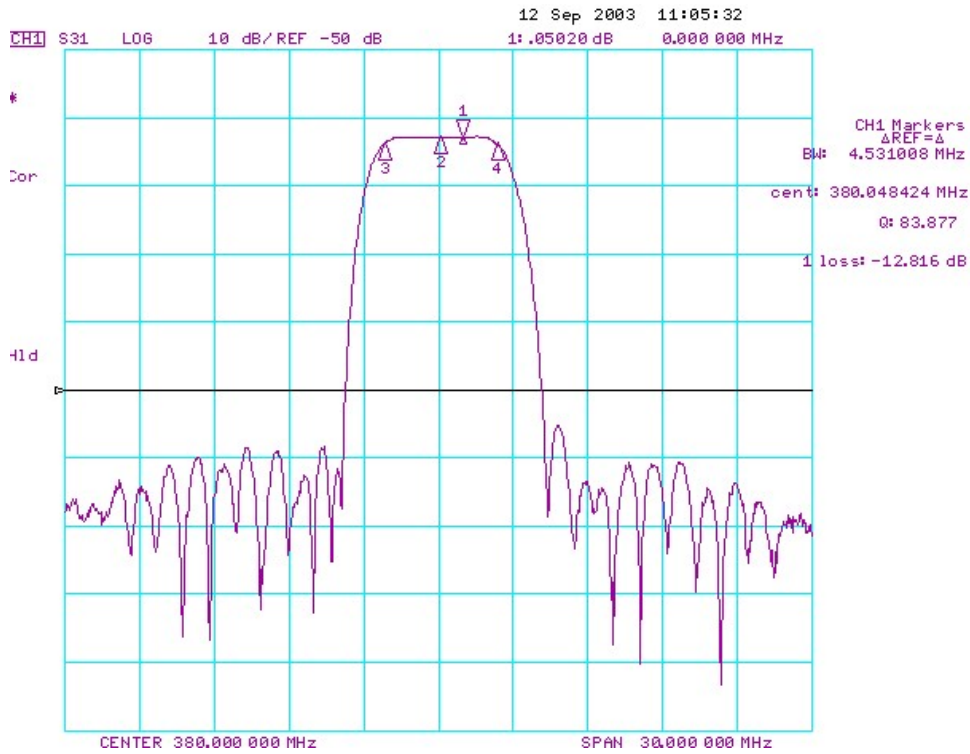

Fig1. Horizontal: 3MHz/Div Vertical: 10dB/Div

2. S21 Response (Group delay ripple of Passband)

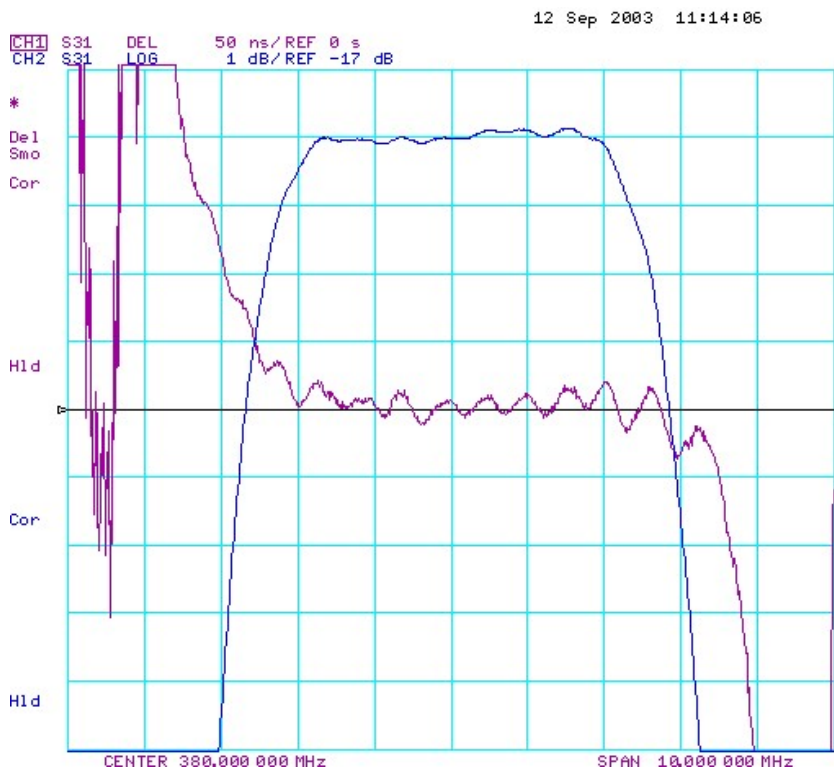

Fig2. Horizontal: 1MHz/Div Vertical: 1dB/Div
Vertical: 50nS/Div

3. S21 Response (Phase linearity of Passband)

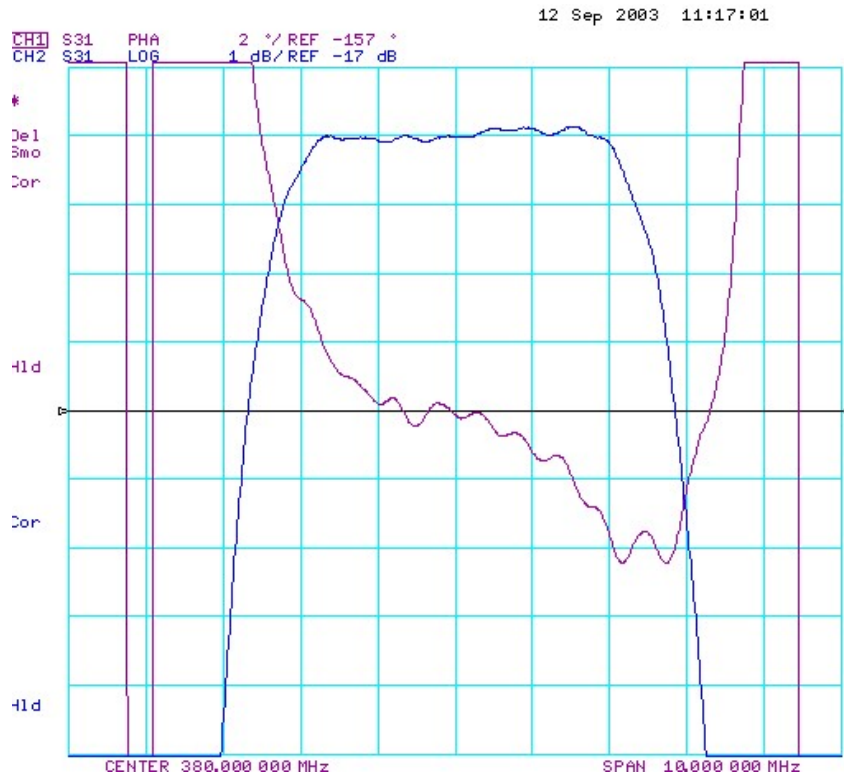
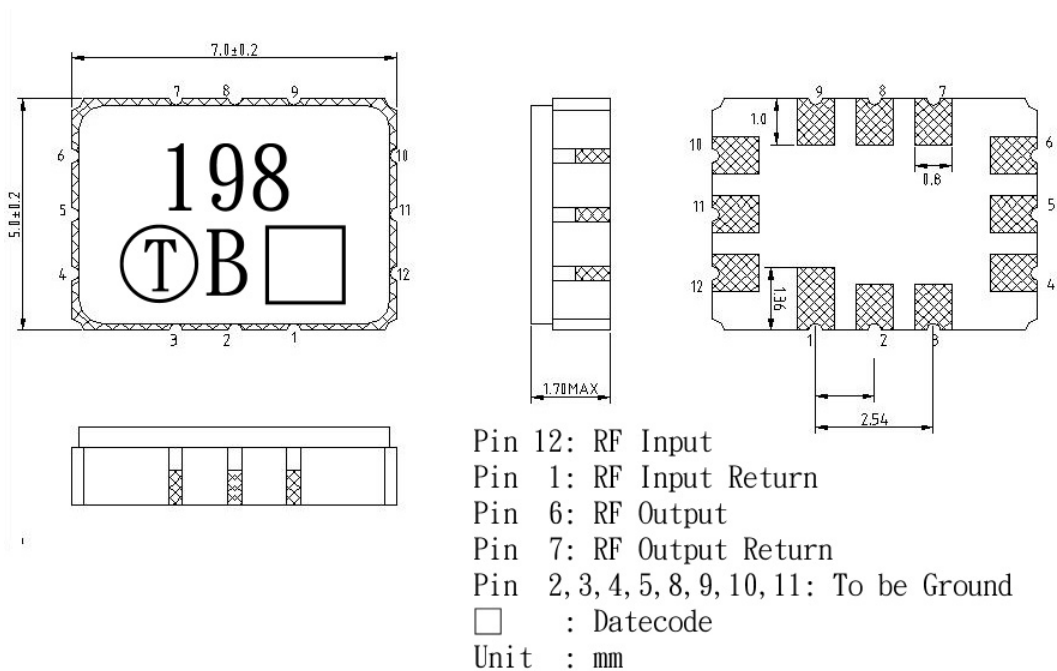

Fig3. Horizontal: 1MHz/Div Vertical: 1dB/Div
 Vertical: 2 degree/Div

E. Outline Drawing:



F. PACKING:

1. REEL DIMENSION

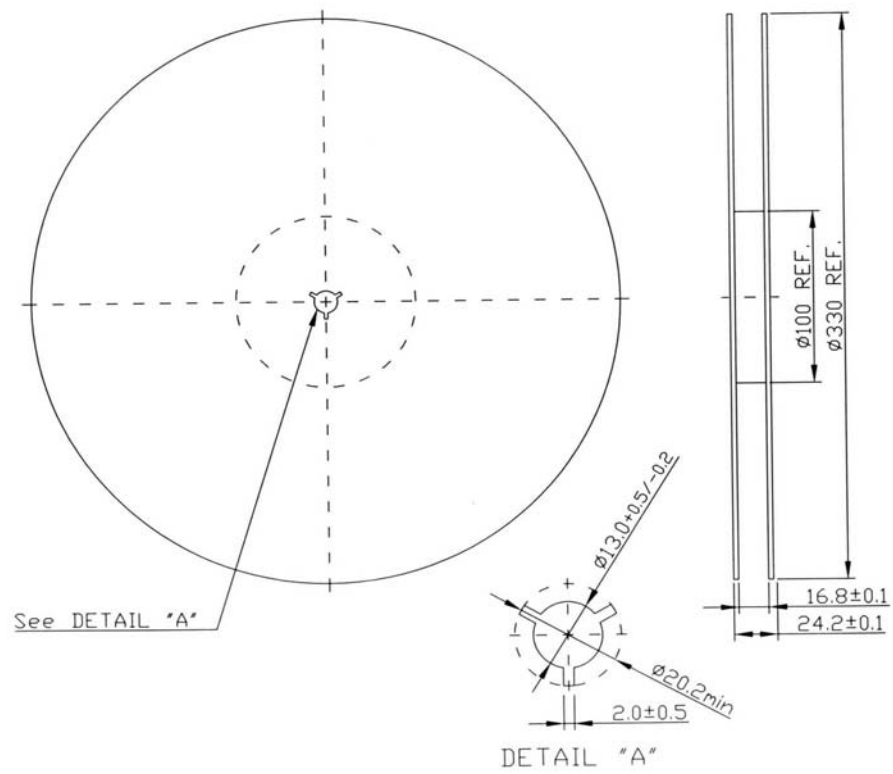

2. TAPE DIMENSION

